

Product Description

The **CB 4-s** is our most popular wall-mounted call box and is highlighted by our durable carbon steel construction and hands-free emergency speakerphone that provides direct communication with first responders. Available with a remote mount LED beacon/strobe or Audio Paging System, it can extend security efforts to dorm and building entrances, hallways and transit centers.

Standard Features

- ✓ Durable 0.078-inch steel construction
- ✓ Wall Mounting Hardware Included
- ✓ Small footprint enclosure



Popular Upgrades



ToolVox™ XV
Virtual Machine



ToolVox™ XS
Server



Managed Cloud Solutions



Remote Mounted
Strobe



Hearing Loop



Dual Faceplate Opening

This product can be ordered with a secondary faceplate opening, designed for use with directory/informational plates or third-party accessories. Contact Customer Service or see our Dual Faceplate Options product sheet for more details.

Technical Features

Specifications

- **Height:** 13.29" (33.76 cm)
- **Width:** 10.25" (26 cm)
- **Depth:** 6" (15.2 cm)
- **Weight:** 11 lbs. (4.9 kg)
- **Material & thickness:** 0.078" steel
- **Standard Power:** 12-24V AC/DC
- **Optional Power:**
 - 120-277V AC
 - PoE

Communication

- **Speakerphone Options**
 - **LS1000*/LS2000:** Full Duplex, SIP Compatible VoIP
 - Phone. **IA4100:** Analog full duplex phone.
- **Connection Options**
 - Hardwired
 - Cellular
 - IP Wireless

Style

- **Standard wet coat paint options:**
Safety Blue, Safety Yellow, Safety Red, Gloss White, Bright Silver, Tiger Orange, Midnight Blue, Gloss Black, Dark Bronze, Cardinal Red, Medium Bronze, British Racing Green, Architectural Gray, & Oak Buff.
- **Standard Graphics text options:**
Emergency, Assistance, Help Point, Police, Courtesy, Security, Information
- **Standard Graphics text colors:**
White, Black, Blue, Red, Green, Yellow, Orange, Purple, & Brown
- **Custom Paint Colors, Graphic Colors, Graphic Text & Fonts also available.**

Compliance

- UL 62368-1
- Built to NEMA 4 Specifications
- Designed to ADA Specifications



*(For single faceplate opening) When ordering enclosure with the LS1000 speakerphone that includes an Axis camera and cellular service equipment, an externally mounted NEMA housing is required to ensure proper operation.

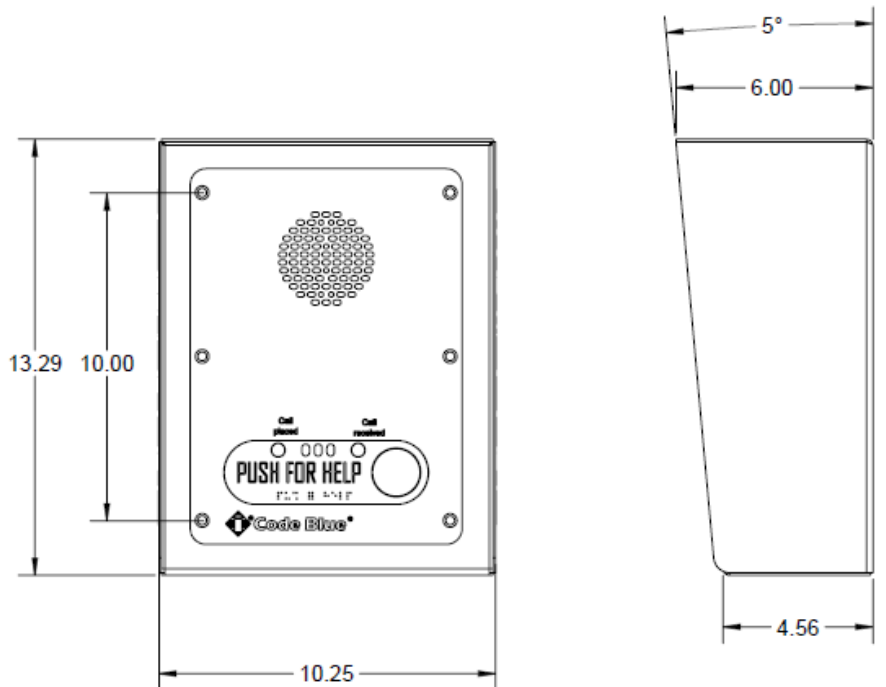

FRONT VIEW

SIDE VIEW

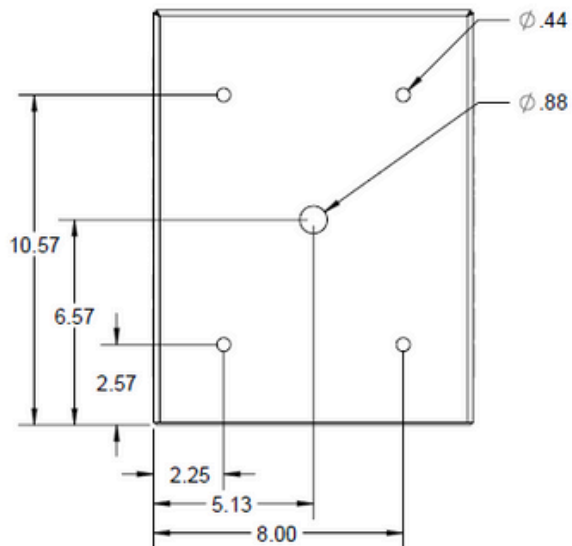

BACK VIEW

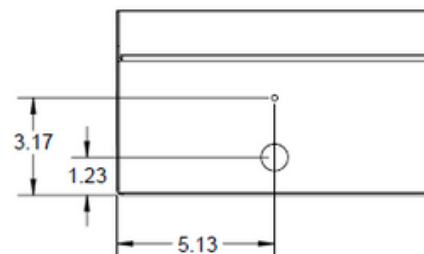

BOTTOM VIEW

Note: Specifications subject to change without notice or obligation on the part of Code Blue Corporation.