

Product Description

Code Blue has three varieties of **equipment mounting rings** available as optional features for the CB1 Series Tower Help Points® that allow you to internally and externally mount third party communication and security equipment with your unit to enhance connectivity and functionality.

Standard Features

- ✓ 0.25" carbon steel construction
- ✓ Weather, vandal and UV resistant internal storage space for third party devices
- ✓ Rugged external mounting bracket for attaching third party devices, antennas, etc.

Available For:

- CB 1-e
- CB 1-s

Specifications

5.25" Equipment Ring with 16" Post

- **Ring Height:** 5.25" (6.75" with inset) (13.33/17.15 cm)
- **Outside Diameter:** 12.75" (32.39 cm)
- **Antenna Post:** 1.31" Diameter x 16.00" H
- **Thread:** 1.00" NPT

5.25" Equipment Ring with 8" Post

- **Ring Height:** 5.25" (6.75" with inset) (13.33/17.15 cm)
- **Outside Diameter:** 12.75" (32.39 cm)
- **Antenna Post:** 1.31" Diameter x 8.00" H
- **Thread:** 1.00" NPT

5.25" Equipment Ring

- **Height:** 5.25" (6.75" with inset) (13.33/17.15 cm)
- **Outside Diameter:** 12.75" (32.39 cm)
- **External Equipment Mounting Arm**

Paint Color Options

- **Standard Colors:** Safety Blue, Safety Red, Safety Yellow, Gloss Black, Gloss White, Bright Silver, Dark Bronze, Medium Bronze, Midnight Blue, British Racing Green & Tiger Orange
- **Custom Colors & Clear Coat Options Available Upon Request**

Included Components

- **Conepoint Set Screws:** Set of 3 screws included with all Equipment Ring models.
- **Internal Equipment Shelf:** 1 shelf included with all Equipment Ring models.

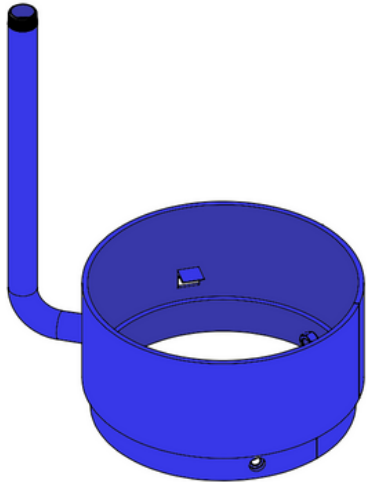

5.25" Equipment Ring
with 16" Post

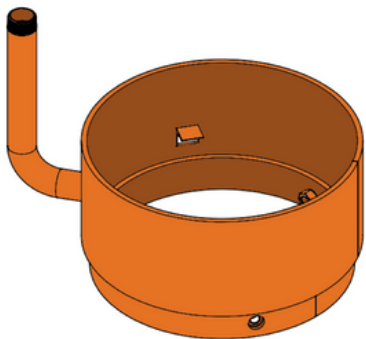

5.25" Equipment Ring
with 8" Post



5.25" Equipment Ring



Dimensions

5.25" Equipment Ring with 16" Post

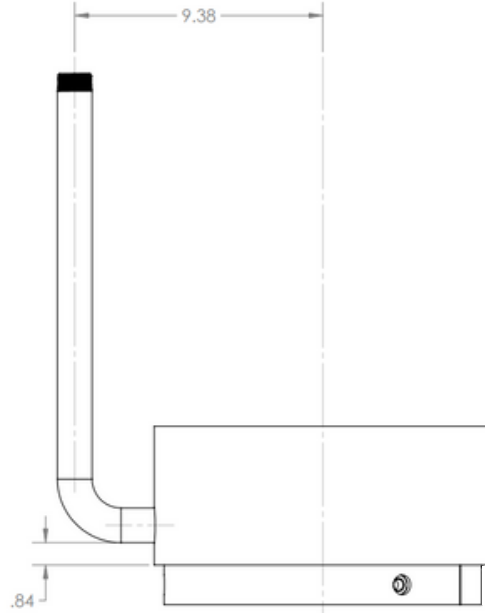
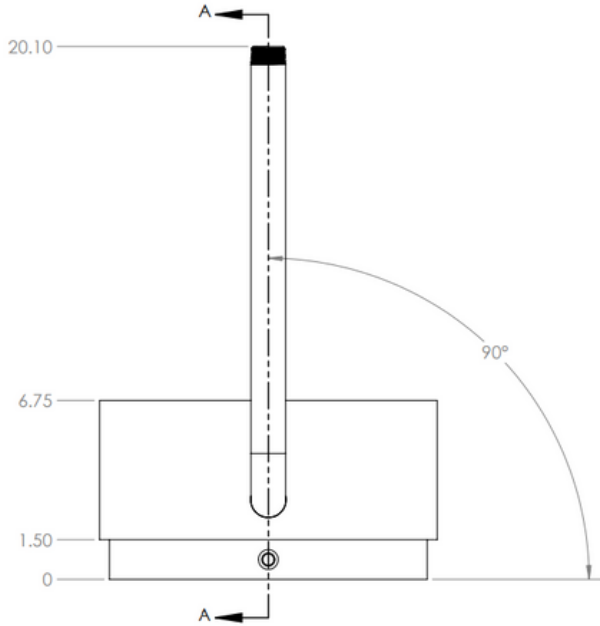

5.25" Equipment Ring with 8" Post

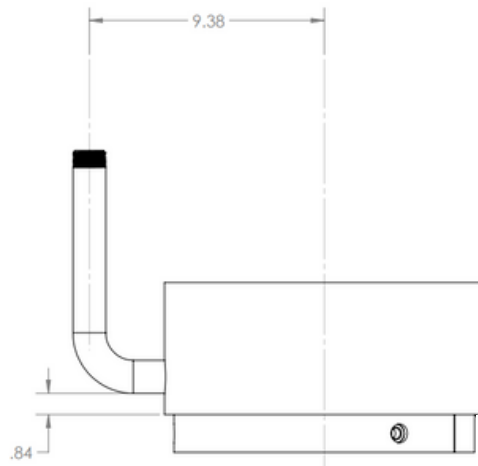
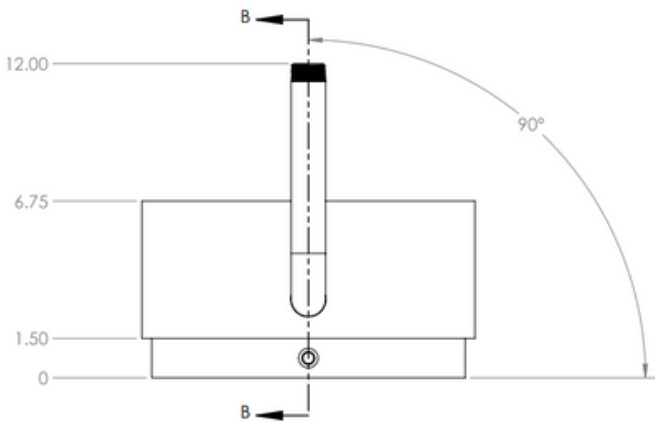

5.25" Equipment Ring

