



Code Blue®



TECHNOLOGY
INTEGRATION
PARTNER

Product Description

The newest configuration of **LS1000 VoIP Speakerphone**, combined with the **Axis F2105-RE Sensor & F9111 Main Unit**, delivers a powerful combination of functionality & reliability to meet your Help Point® needs. Providing a 108° field of view, along with 1080p resolution, the camera is designed to deliver clear video footage, even in rough conditions. This union of industry leading voice communication and first-class video verification will add additional layers of strength and dependability to any Code Blue ecosystem.

Standard Features

- ✓ Full duplex communication
- ✓ 12V DC or PoE Power availability
- ✓ Proprietary screws for vandal resistance
- ✓ 1080p Resolution Axis Communications Camera
- ✓ Piezoelectric buttons that won't stick or jam

Compatible Enclosures

- ✓ CB 1 Series Towers
- ✓ CB 2-a*, 2-e, & CB 2-s Wall Mount Enclosures
- ✓ CB 4-r*, CB 4-s*, & CB 4-u Wall Mount Enclosures
- ✓ CB 5 Series Towers
- ✓ CB 6 Series Speakerphone Enclosures*
- ✓ CB 9 Series Towers
- ✓ CB-RT Towers

*CB 2-a, CB 4-r, CB 4-s(single faceplate opening), & CB 6 Series enclosures ordered with the LS1000 Speakerphone including an Axis Camera along with Cellular Service equipment will require the use of externally mounted NEMA housing for the cellular equipment in order to properly function. Please contact Customer Service for complete details.



Popular Upgrades



ToolVox™ XV
Virtual Machine



ToolVox™ XS
Server



Managed Cloud Solutions



BLUE ALERT

Speakerphone Technical Features



Specifications

- **Height:** 11.75" (29.85 cm)
- **Width:** 8.5" (21.59 cm)
- **Depth:** 2.5" (6.35 cm)
- **Weight:** 9 lbs (2.72 kg)
- **Contact Closures-IN:** 3
- **Contact Closures-OUT:** 3
- **Ethernet Ports:** 3
- **Phone Power:** 12v DC or PoE
- **RAM:** 4GB
- **Operational Temperature:** -40° C to 70° C (-40° F to 158° F)

Functionality

- Line Level Audio Output: 8 ohm
- Peer-to-peer audio communication
- Number storage

Faceplate

- Piezoelectric data buttons
- ADA Braille bezels
- Conformal coated PCB
- 2 LED status indicator lights

Style

- **Standard Large Bezel Text:**
 - "Push For Help" - Red Text/White Bezel
 - "Emergency" - Red Text/White Bezel
 - "Assistance" - Black Text/White Bezel
- **Standard Small Bezel Text:**
 - "Call" - Black Text/White Bezel
 - "Info" - Black Text/White Bezel
- **Custom Options Available:** See "Premium Bezel Options" Product Sheet or contact Customer Service to learn more!

Compliance

- Built to NEMA 4 Specifications
- Designed to ADA Specifications

SPEAKERPHONE
FRONT VIEW

SPEAKERPHONE
SIDE VIEW

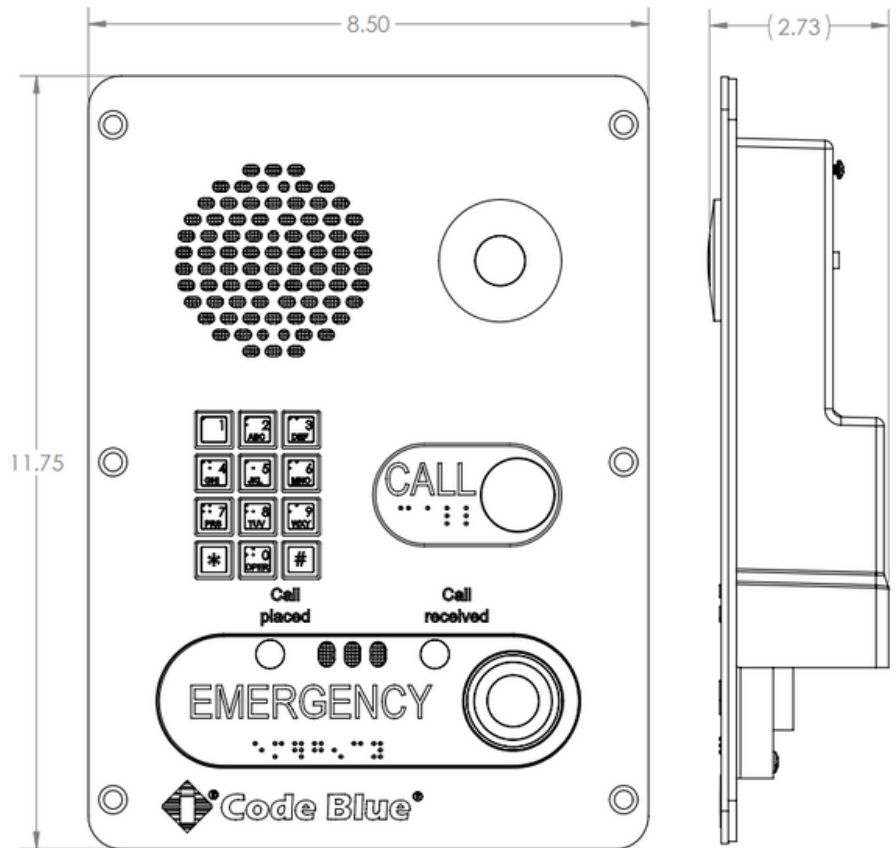

Available Configurations

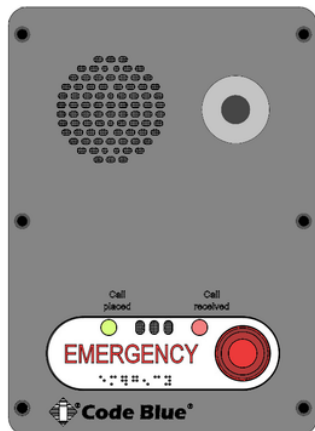

SINGLE BUTTON



DOUBLE BUTTON



DOUBLE BUTTON W/ KEYPAD

Note: Specifications subject to change without notice or obligation on the part of Code Blue Corporation.

Camera & Video Specifications



- **Image sensor** 1/2.8" progressive scan RGB CMOS
- **Lens** 3.1 mm, F2.0
 - M12 mount, fixed iris
 - **For 1080p:**
 - Horizontal field of view: 108°
 - Vertical field of view: 58°
 - **For 720p:**
 - Horizontal field of view: 70°
 - Vertical field of view: 39°
- **Minimum illumination**
 - Color: 0.1 lux
- **Day and night** Fixed IR-cut filter
- **Shutter speed With AXIS F9111:**
 - 1080p, 25/30 fps: 1/20000 s to 1.5 s
 - 1080p, 50/60 fps: 1/27000 s to 1 s
 - HDTV 720p, 175/180 fps: 1/32500 s to 0.5 s
- **Casing**
 - IP66-, IP67-, IP6K9K-a, NEMA 4X-rated
 - Aluminum
 - Color: black NCS S 9000-N
- **Sustainability** PVC free
- **Camera Assembly Power:** PoE or 12-24V DC
 - Draw: Typical 1W, Max 1.7W
- **Connectors** SMA connector
- **Operating conditions**
 - -40°C to 60 °C (-40°F to 140 °F)
 - Maximum temperature according to NEMA TS 2 (2.2.7): 74 °C (165 °F)
 - Start-up temperature: -40 °C (-40°F)
- **Storage Conditions**
 - -40 °C to 65 °C (-40 °F to 149 °F)
 - Humidity 5-95% RH (non-condensing)

Video

- **Sensor:** 1/2.8" Progressive Scan RGB CMOS
- **Lens:** Fixed 3.1mm
 - Horizontal Field of View: 108°
 - Vertical Field of View: 58°
- **Minimum Illumination:** 0.1 lux
- **Resolution:** 1920x1080 HDTV 1080p
- **Shutter Speed:**
 - 1080p, 25/30 fps: 1/20000 s to 1.5 s
 - 1080p, 50/60 fps: 1/27000 s to 1 s
- **Codecs:** H.264/ MPEG-4, Motion JPEG
- **Storage:** Slot for microSD/microSDHC/microSDXC
- **ONVIF Profiles:** G and S
- **Day and Night:** IR-Cut Filter & Forensic WDR

SINGLE CHANNEL
MAIN UNIT DIMENSIONS

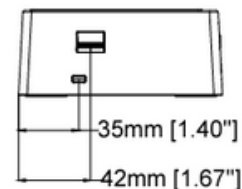
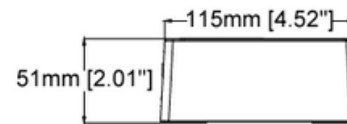
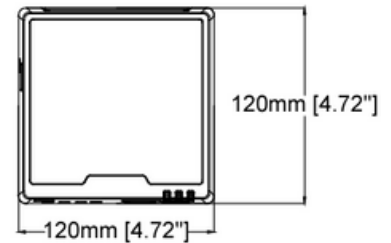
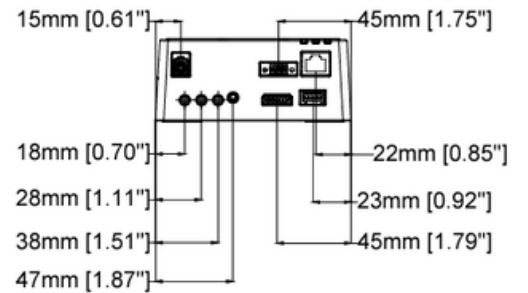

For additional details & specifications, please see Axis product sheets for the F2105-RE Camera & F9111 Main Unit, located at axis.com.

Note: Specifications subject to change without notice or obligation on the part of Code Blue Corporation.

What's Included?

1. Selected Speakerphone Configuration w/ Axis Camera.

2. Single Channel Modular Unit.



3. 3'(1m) Indoor/Outdoor Camera Cable.



4. Required Wire Harnesses & Components for power connections.*



***If you are ordering an LS1000 that includes a camera, along with a selected Code Blue enclosure, your speakerphone will arrive pre-installed in the enclosure to ensure proper power & communication connections are made. If installation is taking place into an existing enclosure, information on that environment and additional components may be required.**

Before You Order

Before placing an order for an LS1000 speakerphone that includes an camera installed on the faceplate, there are a few things we will need to know before your order can be processed.

- Are you ordering this along with a new Code Blue enclosure/tower, or are you planning to install it into an existing unit?
 - New Unit - Speakerphone with camera will come pre-installed in your new Code Blue tower or enclosure.
 - Existing Unit**
 - Is it a Code Blue Unit?
 - Yes - Please provide the model & voltage present within the unit.
 - No - Please provide the make & model of the enclosure, along with voltage present.***

****If you are ordering this speakerphone model on it's own, without an enclosure, additional components may be required in order to ensure proper functionality. This will depend on the specific incoming voltage & internal power system within the space that the speakerphone will be installed into.**

*****Custom charges may be required if the speakerphone needs to be designed to fit inside an enclosure from another manufacturer.**